

**NZ Machine Knitters' Society Inc**

**Can Knit – Too 2019**

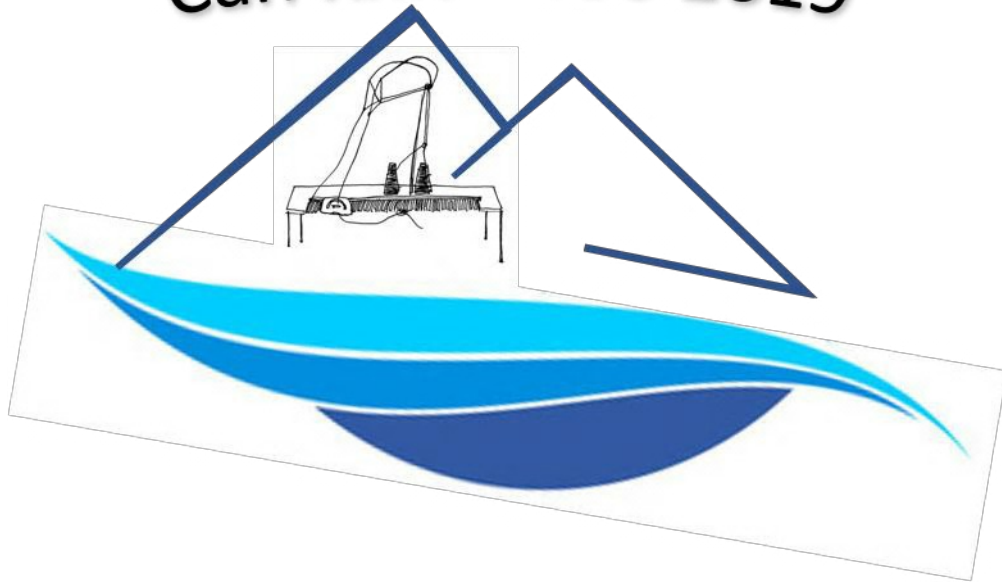

**NATIONAL FESTIVAL 2019**

**Burns Lodge  
89 Church Street  
Mosgiel**

**18 - 22 June 2019**

## **MESSAGE FROM OUR FESTIVAL COMMITTEE**

Once again it is time to think of coming to the Annual Festival of NZMKS Inc. The Can Knit - Too 2019 Festival will be held at Burns Lodge, Mosgiel, from Tuesday 18 - Saturday 22 June. We hope that you will come and join us in Mosgiel for this exciting time.

Now is the time to take a good look at the competition schedule and find one or more classes in which you can display your skills. Competitions are one of the most important aspects of the Festival and they depend entirely on your participation.

We are looking forward to the workshops from our very knowledgeable tutors who continue to stimulate and inspire us with their wide ranging talents and ideas.

Ian Smith has very kindly organised some tours during the festival.

As some members know, Canterbury offered to help with this festival when we were at Rotorua, but it has turned into a Canterbury Festival being held in Otago. We sincerely thank members from Otago and Southland for all the help we have received from them and would appreciate all the support we can get from NZKMS Inc. members and guests - lets make this a Festival to remember.

Jo and the Canterbury Festival Committee

### **INDEX**

Page 2	President's message
Page 3	Can Knit - Too 2019 Information
Page 4	Can Knit - Too 2019 Program Page
5	Tours
Page 6 - 8	Workshop Tutors
Page 9	Workshop Planner
Page 10 - 13	Competition Schedule
Page 14 - 16	Competition Entry Forms - 'Written' and 'To Be Sent with Entry'
Page 17	Workshop and Tour Booking Forms
Page 18	Meals Booking Form
Page 19	Registration Form
Page 20	Area Map
Page 21	Burns Lodge Accommodation Options
Pages 22/23	Info and Day Registration Form added

### **EMAIL ADDRESSES AND PHONE NUMBERS FOR ALL FESTIVAL COMMITTEE MEMBERS**

Jo Johnson	President	jojohanson@xtra.co.nz	03 313 8681
Yvonne Jordan	Secretary	nwyjordan@gmail.com	03 942 3795
Jean Knott	Seminar Organiser	jeanknott83@gmail.com	03 381 4565
Moira Tarry	Workshop Organiser	moiratarry@hotmail.com	027 813 0655
Helen McKessar	Trade Stand Organiser	helen.mckessar90@gmail.com	03 322 4311
Karen Wakelin	Committee Member	mkjc.wakelin@xtra.co.nz	027 813 0655
Avril Jordan	Treasurer	avril.j63@gmail.com	021 991 031

### **CHECK LIST FOR REGISTRANTS**

Have you completed and included (where applicable) your:

- ◆ Registration Form
- ◆ Workshop Booking Form
- ◆ Tour Booking Form
- ◆ Meals Booking Form
- ◆ Cheque to cover your costs, or internet banked same.
- ◆ Stamped self addressed envelope for your receipt and confirmation details or emailed your completed forms to the appropriate person.

**FESTIVAL WEBSITE:** <http://nzmkms.org.nz>

**NZ Machine Knitters' Society Inc**  
**CAN KNIT - TOO 2019**

**INFORMATION PAGE**

**FESTIVAL OFFICERS**

<b>FESTIVAL PRESIDENT:</b>	Jo Johnson	jojohanson@xtra.co.nz
<b>SECRETARY:</b>	Yvonne Jordan	nwyjordan@gmail.com
<b>TREASURER:</b>	Avril Jordan	avril.j63@gmail.com
<b>WORKSHOP ORGANISER:</b>	Moira Tarry	moiratarry@hotmail.com
<b>CHIEF STEWARD:</b>	Heather Smith	iahesmith@gmail.com
<b>SEMINAR ORGANISER:</b>	Jean Knott	jeanknott83@gmail.com
<b>VENUE LIAISON:</b>	Margaret Smith	mlstap@xtra.co.nz

**FESTIVAL VENUE:** Burns Lodge, 89 Church Street, Mosgiel. All events will be held here. Entry is off Church Street.

**JUDGES:** Carol Watson (Chief Judge), Pat Strowger, Laurel Judd (Mentor), Betty Allen (Trainee)

**REGISTRATION FEE:** \$70 per person. Only registered members will be eligible to attend workshops and other Festival functions not open to the public. Please wear your registration name tag at all times.

**ALL FESTIVAL CHEQUES TO BE MADE PAYABLE TO:** Canterbury Area NZMKS

- ◆ Internet Banking Details: Canterbury Area NZMKS 03 0854 0572993-01  
Please include your name and membership number so that we know who the deposit belongs to.
- ◆ All prices quoted in NZ dollars
- ◆ Please post or email registrations to Avril Jordan, 157 Ashgrove Terrace, Somerfield, Christchurch 8024;  
avril.j63@gmail.com phone 021 991 031
- ◆ Please enclose stamped, self-addressed envelope for receipts (NZ only), or we will email receipts to you if you supply your email address. Otherwise, receipts will be in your registration bag.
- ◆ Refunds will be at the discretion of the Festival Committee

**INFORMATION CENTRE:** Will be at Burns Lodge, 89 Church Street, Mosgiel

**ACCOMMODATION & MEALS:** Accommodation will be at Burns Lodge, 89 Church Road, Mosgiel. Motorhomes and campervans are not allowed to overnight on site. Alcohol is allowed on the premises. Motels are available in the area if people don't wish to stay on site, ie. Bella Vista, Regency plus others.

Please contact Bronwyn at Burns Lodge to **book your own accommodation** - Contact [bronwyn@burnslodge.nz](mailto:bronwyn@burnslodge.nz) or phone 03 489 2600. Refer page 21 for accommodation options.

**Note:** Some accommodation is located up stairs and there are no lifts. Book early for ground floor accommodation.

**MEDICAL CENTRES:** Gordon Road Medical Centre, 96 Gordon Road; and Mosgiel Health Centre, 21 Inglis Street.

**WORKSHOPS:** At Burns Lodge, 89 Church Road, Mosgiel. All are disabled accessible.

**SEMINAR & COUNCIL MEETINGS:** Are disabled accessible.

**COMPETITION ENTRANTS:** Please read schedule carefully and note relevant dates.

- ◆ Written competition entries to be posted or emailed to Heather Smith, 93 Jacks Hill Road, RD 5, Invercargill 9875 - iahesmith@gmail.com
- ◆ Entry fees may be internet banked into account Canterbury Area NZMKS 03 0854 0572993-01 Please include name and membership number so that we know who the deposit belongs to.
- ◆ If internet banking competition entry fee/s, please make sure you email your written entry form to Heather Smith.
- ◆ Send **knitted** competition entries to Alma Blaikie, 35 Silverstream Drive, Mosgiel 9024.
- ◆ Please advise Heather Smith, iahesmith@gmail.com, - if you are unable to send any article from your written entry.

Keep copies of all the forms that you send in.

**N.B. The Festival Committee reserves the right to amend, postpone, cancel or substitute any activities as may be deemed necessary.**

**New Zealand Machine Knitters' Society Inc.**  
**CAN KNIT - TOO 2019**  
**PROGRAM**

Tuesday 18 <sup>th</sup> June	2.00pm	Registration opens at Burns Lodge
	5.30pm	Dinner
	6.30pm	Seminar commences
	7.30pm	National Exec Meeting venue TBC
Wednesday 19 <sup>th</sup> June	8.00am	Registration and Information Desk open opposite Reception
	8.30am	Seminar all day
	8.45am	Workshops 3, 12
	10.00am	Morning Tea
	10.45am	Workshops 1, 9
	12.15pm	Lunch
	12.00pm	Tour 1 - Dunedin
	1.00pm	Workshops 6, 13, 18
	2.45pm	Afternoon Tea 3.00pm
		Workshop 2
	4.45pm	Judges Meeting - Grace Library, Room 8
	5.30pm	Dinner
	7.00pm	Official Opening and Prize Giving - Mossgiel Room, Room 14
		Display & Trades Stalls open after prize giving
8.00pm	Judges/Executive Meeting, small room off Holy Cross Community Hall	
Thursday 20 <sup>th</sup> June	8.00am	Registration & Information Desk opens in Community Hall
	8.30am	Council Meeting all day
	8.45am	Workshops 4, 15
	8.30am	Tour 2 - East Otago, Land of Contrast
	9.00am	Trade Stalls Open (and close at 4.00pm)
	10.00am	Morning Tea
	10.45am	Workshops 7, 14
	12.15am	Lunch
	1.00pm	Workshops 5, 10, 16
	2.45pm	Afternoon Tea
	5.30pm	Dinner
	5.30pm	Judges meet Make and Model participants - Grace Library, Room 8
	7.00pm	Make and Model competition commences - The Chapel, Room 1
		Followed by wine and cheese
Friday 21 <sup>st</sup> June	8.00am	Registration and Information Desk opens in Community Hall
	8.30am	AGM - The Chapel, Room 1
	9.00am	Trade Stalls Open (and close at 4.00pm)
	10.00am	Morning Tea
	12.15pm	Lunch
	12.30pm	Tour 3 - Medical Discoveries
	1.00pm	Workshops 20, 22
	2.45pm	Afternoon Tea
	3.00pm	Workshop 11, 17
	3.30pm	Competitors/Judges Meeting - Grace Library, Room 8
	4.30pm	National Exec/2019 Festival Host Meeting - The Chapel, Room 1
	5.30pm	Dinner
7.00pm	National Exec/2020 Festival Host Meeting - The Chapel, Room 1	
Saturday 22 <sup>nd</sup> June	8.00am	Information Desk opens in Community Hall
	8.45am	Workshops 21, 23
	9.00am	Tour 4 - Coastal Dunedin
	9.00am	Trade Stalls open (and close at 2.00pm)
	10.15am	Morning Tea
	10.45am	Workshop 8, 19
	12.15pm	Lunch
	2.00pm	Display and Trades close
	2.45pm	Afternoon Tea
	2.45pm	Pick up garments
6.00pm	Festival Dinner	

**N.B. The Festival Committee reserves the right to amend, postpone, cancel or substitute any activities as may be deemed necessary.**

**New Zealand Machine Knitters' Society Inc. Canterbury Area  
CAN KNIT - TOO 2019**

**TOURS**

All tours depart from the Burns Lodge car park. Flat comfortable walking shoes and a warm coat are advisable on all tours — it's winter time. Seats may be limited on some tours due to the configuration of transport. We will try our utmost to accommodate you all. We will notify you as soon as possible after registrations close if we cannot fit you on a tour.

The Festival Committee reserves the right to cancel any tour that does not have sufficient numbers to make it viable. All tours include all listed items in the cost unless otherwise stated.

**TOUR 1 DUNEDIN**

**Cost: \$60.00**

**Wednesday 19th June**

**Depart 12.00pm**

**Return 5.30pm**

Entry fee and afternoon tea provided.

Visit Dunedin viewpoint.

Speights Ale House tour.

Visit to Early Settlers Museum and Railway Station

**TOUR 2 EAST OTAGO, LAND OF CONTRAST**

**Cost: \$90.00**

**Thursday 20th June**

**Depart 8.30am**

**Return 5.30pm**

Lunch, morning and afternoon teas provided.

First Choice, weather permitting : Via Middlemarch, view Oceania McRaes mine (come and see an impressive hole in the ground), to Palmerston, then coastal from Karitane via Port Chalmers

Alternative if weather unsuitable : To Oamaru via Trotter's Gorge and Moeraki and coastal from Karitane. At Oamaru take in the history, including that of the Oamaru stone and buildings.

**TOUR 3 MEDICAL DISCOVERIES**

**Cost: \$30.00**

**Friday 21st June**

**Depart 12.30pm**

**Return 5.30pm**

Afternoon tea provided.

Visit to Otago University - a rare opportunity to learn about your body and what can go wrong.

Meet with professionals who have a passion for sharing their behind the scenes work. Visit Anatomy and Pathology museum. Interactive discussion about Cancer and Genetics. Visit to the diagnostics lab

to find out what happens with blood tests.

**TOUR 4 COASTAL DUNEDIN**

**Cost: \$95.00**

**Saturday 22nd June**

**Depart 9.00am**

**Return 4.30pm**

Entry fees, lunch, morning and afternoon teas provided.

Otago peninsula plus. Visit Glenfalloch Gardens, Larnach Castle, Portobello for lunch, following along the ridge line road to Brighton, Taieri Mouth and across to Lake Waihola.

Looking forward to seeing you all in Mosgiel

Ian Smith - Phone 027 232 0138 or email [iahesmith@gmail.com](mailto:iahesmith@gmail.com) with any queries.

<b>WORKSHOPS</b>		
<b>TUTOR</b>	<b>PROFILE</b>	<b>TOPIC</b>
<b>Anne Baxter</b>	<p>Anne has been involved in the NZMKS at Area level for over 30 years. She is currently a Southland Councillor. Anne has her own shop in Gore which sells hand knitting yarns, crochet and knitting books, haberdashery as well as knitted garments.</p>	<p><b>Workshops 1 &amp; 2</b></p> <p><b><u>ADDED BITS</u></b></p> <p>When you add bits to your garments you make them individually one offs made by you. It can be embroidery, fancy buttons, crochet, lace, braids or whatever but when you add those extra bits to your garments you make them special. They are unique to you. Those added on bits make something quite ordinary turn into something quite special.</p>
<b>Barbara Wills</b>	<p>Machine knitting for Barbara started around 1975 when she bought a Singer 323 Memomatic. Learning was manual and Barbara joined the local Machine Knit Group, where various hints and tips were shared.</p> <p>Machine knitting took a rest for a while owing to Barbara's involvement with several service groups including Scouting, Neighbourhood Support, and Red Cross.</p> <p>Barbara has various machines - Brothers 930, 891, Passap Duo, Singer LK140, Bond, as well as the original Singer 323 Memomatic, concentrating mainly on the Brother 930.</p>	<p><b>Workshops 3, 4 &amp; 5</b></p> <p><b><u>ALTERING THE EXISTING</u></b></p> <p>In this workshop Barbara will help you to investigate how altering something can completely change the look or feel of an article.</p> <p>Different ways of how to bring a new look to something already known will be explored, and how to revive or use up pieces that you may already have.</p>
<b>Barbara Fletcher</b>	<p>Barbara lives in Epping, Sydney, with her husband Ken. She has three children and three grandchildren. Barbara has been knitting for 40 years, and with Passap machines for over 20 years.</p> <p>After retiring, Barbara really started machine knitting like an obsession and addiction. She works with electronic and standard machines as well as DesignaKnit 8 software and she loves it all.</p> <p>Barbara is forever trying to find new ideas to work with and she has the inevitable stash, as well as a collection of machines and accessories.</p> <p>If you are ever in Sydney Barbara extends an invitation to visit her machine knitting club  <a href="http://www.eppingmachineknitters.com">www.eppingmachineknitters.com</a></p>	<p><b>Workshops 6, 7 &amp; 8</b></p> <p><b><u>TECHNIQUES TO EXPLORE AND USE WITH COLOURED YARNS</u></b></p> <p>Using coloured yarns, both solid and variegated, will be the focus of this workshop, exploring the many machine knitting techniques that can be used with an amazing range of coloured yarns. Knitting can be made vibrant, colourful, textural and interesting with some simple ideas and also some more complex techniques.</p>

TUTOR	PROFILE	TOPIC
<p><b>Carol Watson</b></p>	<p>Machine knitting has been a huge part of Carol’s life for the past 40 odd years. She has worked on three different gauges of Brother machines and has tried to conquer the Passap, without great success.</p> <p>Tutoring has widened Carol’s knowledge of knitting and she enjoys sharing her skills with her classes.</p> <p>Carol was invited to join the NZMKS judging panel and has thoroughly enjoyed the experience. Serving as a Councillor for the Southland Area led her to the position of National President.</p> <p>Carol has made many friends in New Zealand and Australia through her knitting.</p>	<p><b>Workshops 9, 10 &amp; 11</b></p> <p><b><u>WORKING FROM YOUR MANUAL - Part 2</u></b></p> <p>In this workshop Carol intends to work with both main and ribber bed, working through the stitches in the manual. As in Part 1, Carol will make a garment using each stitch. She is very much looking forward to meeting you all.</p>
<p><b>Doreen Berge</b></p>	<p>Doreen has been knitting since the late 1960’s and has learnt a lot from others over the years. She has taken this learning and mixed it with her own ideas to solve many ‘challenges’ when knitting with different yarns, stitch types, and ‘Creative’ ideas.</p>	<p><b>12, 13 &amp; 14</b></p> <p><b><u>I DID IT MY WAY</u></b></p> <p>As many knitters have been knitting a long time, it is a challenge to find something that will be useful and used.</p> <p>When discussing something with a knitter at the last Festival (to do with knitting of course!) and explaining how I did a certain thing, she commented that she didn’t do it like that - so an idea for a workshop was born.</p> <p>This workshop will show you Doreen’s way of doing things.</p>
<p><b>Helen McKessar</b></p>	<p>Helen learnt to hand knit as a child, as did most of her generation, but was never very fast at it. When her now 36 year old son was born she knew that she either had to start knitting his school uniform jersey right then, or buy a knitting machine like her Mum’s. The knitting machine won and has been in use ever since.</p> <p>These days most of Helen’s knitting goes to children’s charities.</p>	<p><b>Workshops 15, 16 &amp; 17</b></p> <p><b><u>STITCH MANIPULATION</u></b></p> <p>Susan Guagliumi has most graciously consented to the use of her intellectual property in this workshop. She has, however, stated that no items may be photocopied from her books. She prefers to think that you will buy her books yourselves. That said, her books ‘Hand Manipulated Stitches for Machine Knitters’ and ‘More Hand Manipulated Stitches for Machine Knitters’ are the basis of this workshop. Don’t be put off by the heading ‘Hand Manipulated’. The methods looked at will not be difficult or arduous but will give a whole new field of texture to any item.</p>

TUTOR	PROFILE	TOPIC
<b>Jo Johnson</b>	As a teenager (and being a ward of the state) waiting to be old enough to start nursing training, Jo worked on a farm in Southland looking after a 16 month old boy. His mother had a Knitmaster main bed knitting machine and when Jo was hand knitting a jumper for herself, she suggested Jo use her machine. After this Jo was hooked. Years later with 4 young girls Jo met a lady who was selling her 830 machine to upgrade to an 881. The rest, as they say, is history.	<p style="text-align: center;"><b>Workshops 18 &amp; 19</b></p> <p style="text-align: center;"><b><u>A LITTLE BIT OF THIS AND A LITTLE BIT OF THAT</u></b></p> <p>This workshop is about sharing some of the things I have learnt over the many years of knitting - different ribs, lace, intarsia etc.</p>
<b>Pat Strowger</b>	Pat has been hand and machine knitting longer than she likes to think about but she still enjoys both and helping others learn. Pat got her knitting machine when her children were little and is now knitting for great grandchildren - this says it all.	<p style="text-align: center;"><b>Workshops 20 &amp; 21</b></p> <p style="text-align: center;"><b><u>ENHANCING KNITWEAR</u></b></p> <p>This is a hands on workshop. Knitters need to bring a piece of knitting 100 stitches by 100 rows in 4ply wool any colour, or a finished plain st.st garment they would like to add to. Knitters need to bring scissors, assortment of sewing needles and scraps of 4 ply yarns, embroidery cottons, and beads.</p>
<b>Ruth Stick</b>	<p>Ruth's interest in knitting began when her mother taught her to hand knit in her childhood. She bought her first knitting machine in 1973 and knitted for Ivan, their children, family and friends.</p> <p>Ruth has been a delegate for the last 18 years - 6 years in Marlborough and then in Manawatu where she has been an active member for the past 12 years.</p> <p>Ruth enjoys knitting and is always on the lookout for an easier way !! Or a shortcut !!</p> <p>Ruth is known in Manawatu as the 'Gadget Girl' and she loves to share her knowledge and ideas, and to help fellow knitters.</p>	<p style="text-align: center;"><b>Workshops 22 &amp; 23</b></p> <p style="text-align: center;"><b><u>GADGETS !!!</u></b></p> <p>There are many Gadgets that we may have in our possession - some have come with our knitting machines, some we have acquired. These are sitting in our cupboard and have never been used or have never been mastered.</p> <p>Ruth will show you some of these and how to use them in different ways, so that you too can go home and master yours.</p>





# NEW ZEALAND MACHINE KNITTERS' SOCIETY INCORPORATED

## NATIONAL FESTIVAL COMPETITION SCHEDULE June 2019

### GENERAL INSTRUCTIONS

#### ELIGIBILITY

1. The Competitor must be a financial member of the NZMKS Inc.
2. The Chief Steward must be a non-competitor in all classes at the current Festival

#### ENTRIES

3. All Entries must be the work of the Competitor.
4. Competitors must use the official entry forms and comply with competition rules.
5. All entries must be knitted on a knitting machine unless otherwise stated.
6. Garments or articles entered at a previous NZMKS Festival will not be accepted/eligible.
7. All entries must be thoroughly clean and dry or they will be disqualified.
8. Any entry not entered in the correct class will be disqualified and not redirected.

#### CATEGORIES

- a. Novice: N1 - N4 Open only to those competitors who have never won a 1st prize or the Novice Cup in a NZMKS Inc. Festival Competition.  
**N.B.** Novice knitters may also enter any other Sections schedule. The Novice Cup will be awarded to the competitor who has gained the most points and has entered all four classes in the Novice Section.
- b. Classic: CL1 - CL5. Open to all competitors.
- c. Open: O1 - O11 Open to all competitors.
- d. Championship Challenge: Open to all competitors in order to find the winner of the Champion Challenge. The competitor must have an entry in each of the three classes to be eligible to win the Championship Cup. The winner will not be asked to be guest exhibitor at the following Festival.

#### GUIDELINES

1. An entry is one or more pieces. An outfit is one or more pieces and can be worn without the need for additional clothing.
2. Any method of seaming may be used in all classes.
3. Any welts, strapping, neckband or waistband may be used.
4. At least 75% (at judges' discretion) of any entry, excluding lining, must be machine knitted unless otherwise stated. The rest of the entry may combine with any other craft/fibre technique (hand knitting, crochet, felting etc) and may use any type of fabric or other material for embellishment. In the classic section the entry must be fully machine knitted.
5. Samples of yarn and all materials used must be attached to entry.
6. Treated fabric: A sample of the original knitting must be included with the entries that have been fused, treated, felted, or lined.
7. Accessories, unless knitted, are not judged as part of the entry.
8. Any type of yarn/fibre may be used in any class unless otherwise stated.
9. Insurance cover on all entries is the Competitors own responsibility. Please insure your entries from time of dispatch until return.
10. Judging: During Judging, the area must be closed to everyone except for Stewards and Judges.
11. "Computer Aided" (Susan Lazear Trophy) means some computer-type program used, e.g. Cochenille Garment Designer, Cochenille Stitch Painter, PPD, DesignaKnit, etc., not just a built-in pattern in a computerised knitting machine.

**THE JUDGES' DECISIONS ARE FINAL AND NO CORRESPONDENCE WILL BE ENTERED INTO.**

#### POINTS SYSTEM USED THROUGHOUT FESTIVAL

1st = 5 points, 2nd = 3 points, 3rd = 2 points, Highly Commended = 1 point  
Note that 1st equal = 5 points, 2nd equal = 3 points, 3rd equal = 2 points

#### JUDGES SCALE OF MARKS

Marking for	Novice and Open Classes		called	General
	To	be		
		Classic Section		
Presentation	20			20
Fabric, Seaming, Finishing	20			40
Design	50			30
Degree of Difficulty	10			10

Two Judges judge each garment separately and together, each scaling from 100 marks.  
Total scores are added together and divided by two to get the average.  
Each entry has a class identification number attached where applicable.  
There is no possibility of a judge knowing who knitted the entry or where it came from.

## TROPHIES

<b>CAPITAL SHIELD:</b>	Awarded to winner of Host Area's Own Choice class.
<b>ELSPETH COKER MEMORIAL TROPHY:</b>	Awarded to best Baby/Pre-school entry over all classes.
<b>IDA ENGLISH TROPHY:</b>	Awarded for the most creative entry incorporating weaving.
<b>CITY OF SAILS TROPHY:</b>	Awarded for best entry in wool. Up to 5% non-wool or specialty fibres may be used for visual decoration only.
<b>SUSAN LAZEAR AWARD:</b>	Awarded for the best computer aided entry, with focus on original fabric or creative garment shape or both. See Guidelines 11
<b>JOHN Q DESIGNER CREATIVE AWARD:</b>	Awarded for the most creative garment.
<b>CREATIVE CUP:</b>	Awarded for the most creative entry.
<b>DESIGNER TROPHY:</b>	Awarded to the best Designer entry over all classes: finishing secondary.
<b>SUPREME FASHION AWARD:</b>	Awarded to the best Fashion Entry over all classes.
<b>HAWKES BAY CUP:</b>	Awarded to Host Area member gaining most points in Festival Competition.
<b>NOVICE CUP:</b>	Awarded to competitor winning most points (in the Novice Section) and who has entered all four classes in the Novice Section.
<b>AOTEA CUP:</b>	Awarded to the winner of most points in Classic, Open sections.
<b>CHAMPIONSHIP CUP:</b>	Awarded to the winner of most points in the Championship Challenge section.
<b>SHEPHERD TROPHY:</b>	Awarded for the best entry of the competition.
<b>MAKE &amp; MODEL TROPHIES:</b>	Awarded to competitors judged best entry in each section.

### **COMPETITORS: REMEMBER TO READ YOUR SCHEDULE CAREFULLY AND THOROUGHLY.**

<b>NOVICE SECTION</b> One entry per class. (Entry is one or more pieces)	<b>JUDGED</b>
N 1. Baby/child's entry	General
N 2. Adult entry.	General
N 3. Competitor's own choice.	General
N 4. Entry other than garment.	General
<b>CLASSIC SECTION</b> One entry per class (Entry is one or more pieces)	
CL 1. Entry in plain stocking stitch (one colour and must be in wool)	Classic
CL 2. Entry with variations of reverse stocking stitch patterning (e.g. garter stitch)	Classic
CL 3. Entry featuring single bed stitch, any yarn.	Classic
CL 4. Entry featuring double bed stitch, any yarn	Classic
CL 5. Socks.	Classic
<b>OPEN SECTION</b> may enter more than one entry per class (an entry is one or more pieces)	
O 1. Baby's entry.	General
O 2. Pre-schooler's entry.	General
O 3. Child's entry 5 - 12years.	General
O 4. Teens wear.	General
O 5. Ladies' sports / leisure / casual wear.	General
O 6. Ladies' fashion entry.	General
O 7. Menswear.	General
O 8. Novelty or toy.	General
O 9. Fashion accessory/accessories - one piece or combinations of two or more pieces - bag, belt, scarf, shawl, jewellery, hat etc.	General
O 10. Home furnishing or home accessory.	General
O 11. Festival Area's own choice "Anything Other Than a Garment"	General

Judges own choice

<b>CHAMPIONSHIP</b> Three entries to be judged collectively	Judges own choice
Each entry to comprise -	
A Child's entry up to 12 years	A Woman's Fashion entry
	A Male entry

Marking for this will be based on the skilled use of:

### **CLASS M 1 CHILDREN'S SPECIAL**

Open to all children or grandchildren of Society members, up to 15 years, to enter an article or garment  
No entry fee. Prize money will be awarded. This will be judged - Judges' own choice

### **CLASS M 2 OVER 80'S SPECIAL**

Competitor's own choice - article or garment

---

## **MAKE AND MODEL**

(A) Single Item of Clothing                      (B) Multi Piece Outfit

See Society Festival By-Law No.222 (appended)

Judged as Judges Own Choice Only NZMKS Inc. members attending Festival may enter.

Competitors may enter (A) and/or (B). Entries must be machine knitted and the complete work of the Competitor.

The entry worn in one section of the Make and Model must not be incorporated into the other section.

Any method of construction and seaming may be used.

Entries are NOT eligible for any other Awards or Trophies.

Entry into this section will be closed as advertised in the Festival Newsletter. (Rule 222f)

Competitors will be disqualified if not present at the published reporting time.

Competitors are responsible for their own insurance.

General instructions and guidelines (in particular, guideline 4) apply.

### **Festival By-Law 222**

The make and Model Section of the Competition must be included in the Festival Schedule, and is governed by the following By-Laws, which are subject to review by the Council from time to time, and are applicable only to this section.

- a. Any individual financial member who will be attending the Festival and not directly involved with the judging of this section may enter. Competitors may enter into either or both classes; the garment(s) worn in one section (class) must not be incorporated into the other section (class)
- b. The entry must be the complete work of the competitor.
- c. The entry must be machine knitted.
- d. Garments entered in a previous Society National Festival competition will not be accepted.
- e. The Festival Hosts have the right to limit the number of entries but notice of their intention to do so must be in the Festival Newsletter.
- f. The closing date for written entries shall be at the discretion of the Festival Host Committee and be advised in the Festival Newsletter.
- g. Garments are to be brought to the Festival by competitors and not displayed prior to their judging. Competitors will be disqualified if the published reporting time is not adhered to.
- h. The current Festival Judges will judge the Make and Model section.
- i. Garments will be judged while being worn by the knitter competitor.
- j. Entries are not eligible for consideration for any Society trophies other than the Make and Model trophies at the current National Festival.
- k. Judges decisions are final and no correspondence will be entered into

## Judging Criteria Suggestions

### **Presentation**

#### **Eye Appeal**

- Pattern execution
- Pressing/steaming
- Distortions

#### **Fabric, Seaming & Finishing**

- Sleeves/ sides/ neck sides same length
- Welts/ strapping/ neckband (tension only)
- Suitability of tension of yarn to pattern used
- Slubs/ pulls/ flaws/ knots/ pull strains
- Cast on / off
- Matching ribs and seams (continuous)
- Shoulder seams
- Sleeve - attachment of Suitability of seaming
- Neatness of seaming
- Matching of increases/ decreases on seams
- Attaching of buttons

#### **Design**

- Strapping/ welts/ neckband (proportion)
- Neck size/ openings
- Suitability of yarn and colour to pattern and garment design
- Pocket - size and position
- Design features
- Collars, pockets etc
- Originality
- Creativity

#### **Colour**

- Pattern used/ matching
- Patterns balance on garment pieces
- Suitability of trimmings/ buttons/ added features
- The features which make the entry individual and special
- Use of colour
- Originality

#### **Degree of Difficulty**

The appropriate techniques used in a garment judged in relation to other entries in the same class; how successfully these techniques have been used.

New Zealand Machine Knitters' Society Inc

Form A.

CAN KNIT - TOO 2019

COMPETITION "KNITTED" ENTRY FORM TO BE SENT WITH ENTRY

Entries to be post marked no later than Thursday 6<sup>th</sup> June 2019.

NB. For overseas entries, make sure they are posted in plenty of time to reach us.

Name:..... Phone:.....

Address.....

..... Email:.....

Membership No:..... Total no. of entries in this parcel.....

Class Numbers:.....

How are your entries to be returned? Collect..... Post..... Courier..... Other (please state).....

Total Amount enclosed for return of entries, or prepaid Courier Post ticket:.....

Knitted Competition Entries to be sent to:

Alma Blaikie, 35 Silverstream Drive, Mosgiel 9024

- ◆ Please note - entries may not be collected until 2.45pm Saturday 22<sup>nd</sup> June 2019.
- ◆ Presentation of your receipt is required when collecting your entry/s.
- ◆ Please notify **Heather Smith** if items for which you have forwarded a WRITTEN entry are not being sent.

New Zealand Machine Knitters' Society Inc

Form B

CAN KNIT - TOO 2019

COMPETITION "KNITTED" ENTRY FORM TO BE SENT WITH ENTRY

CHILDREN'S SPECIAL

Entries to be postmarked no later than Thursday 6<sup>th</sup> June 2019.

NB. For overseas entries, make sure they are posted in plenty of time to reach us.

Child's Name:..... Age of Child:.....

Name of Parent/Grandparent..... Membership No of Parent/Grandparent.....

Address of Child:.....

Total no. of entries in this parcel.....

Class Number:.....

How are your entries to be returned? Collect..... Post..... Courier..... Other (please state).....

Total Amount enclosed for return of entries, or prepaid Courier Post ticket:.....

Entries to be sent to:

Alma Blaikie, 35 Silverstream Drive, Mosgiel 9024

- ◆ Please note - entries may not be collected until 2:45pm on Saturday 22<sup>nd</sup> June 2019.
- ◆ Presentation of your receipt is required when collecting your entry/s.
- ◆ Please notify **Heather Smith** if items for which you have forwarded a WRITTEN entry are not being sent.

New Zealand Machine Knitters' Society Inc.

CAN KNIT - TOO 2019

Form C

CHILDREN'S SPECIAL "WRITTEN" ENTRY FORM

Written entries are to be post marked no later than Monday 13<sup>th</sup> May 2019.

Child's Name:..... Age of Child:.....

Name of Parent/Grandparent..... Membership No of Parent/Grandparent.....

Address of Child:.....

.....

How is your entry arriving?.....

ENTRY FEE: Free

Send to:

Heather Smith, 93 Jacks Hill Road, RD 5, Invercargill 9875

Email - iaheSmith@gmail.com - Phone 03 246 9835 or 027 338 3033

PLEASE INCLUDE A STAMPED SELF ADDRESSED ENVELOPE FOR YOUR RECEIPT AND GARMENT LABELS.  
Please keep a copy of this form.

**NB:** If you have more than 1 child/grandchild entering this class, please photocopy this form and send a separate written entry for each child.

New Zealand Machine Knitters' Society Inc.

CAN KNIT - TOO 2019

Form D

MAKE & MODEL WRITTEN ENTRY FORM

Written entries are to be received no later than 12 noon, Thursday 20<sup>th</sup> June 2019.

Name:.....Membership No:.....

Address:.....Area:.....

.....

**Entry Fee:** Free

(A) Single item of clothing

(B) Multi piece outfit

Please indicate (A) and/or (B) with a tick

**Note:** Garments are to be brought to Festival by entrant NOT sent with competition entries.  
Must be accompanied by a brief description of your entry, including yarn used and any special features.

Make & Model will be judged by the NZMKS Inc. Festival judging panel, which may or may not include a guest judge/s.  
Separate prizes will be awarded for the audience selection, decided by audience vote.

New Zealand Machine Knitters' Society Inc.

**CAN KNIT – TOO 2019  
COMPETITION “WRITTEN” ENTRY FORM**

**Written entries** are to be post marked no later than **Monday 13<sup>th</sup> May 2019**

**Send to: Heather Smith**, 93 Jacks Hill Road, RD 5, Invercargill 9875 - Email: [iahesmith@gmail.com](mailto:iahesmith@gmail.com)  
Phone: 03 246 9835 or 027 338 3033

Name: ..... Phone: .....

Address: .....

.....

Email : ..... Membership No.: .....

**PLEASE COMPLETE THE FOLLOWING**

Are you a Novice Knitter – see General Instruction/ Categories No. 9a Yes  No

Are you entering for the Susan Lazear Trophy – see General Instructions/Guidelines No. 11 Yes  No

System Used .....

How are your entries arriving?.....

Please tick the class or classes you wish to enter:

NOVICE	N1	<input type="checkbox"/>	N2	<input type="checkbox"/>	N3	<input type="checkbox"/>
N4	<input type="checkbox"/>					
CLASSIC	CL1	<input type="checkbox"/>	CL2	<input type="checkbox"/>	CL3	<input type="checkbox"/>
CL5	<input type="checkbox"/>					
OPEN	O1	<input type="checkbox"/>	O2	<input type="checkbox"/>	O3	<input type="checkbox"/>
O4	<input type="checkbox"/>	O5	<input type="checkbox"/>	O6	<input type="checkbox"/>	
	O7	<input type="checkbox"/>	O8	<input type="checkbox"/>	O9	<input type="checkbox"/>
	O10	<input type="checkbox"/>	O11	<input type="checkbox"/>		

ENTRY FEES	No. of Entries	Cost	Total Cost
Novice, Classic & Open Entries:		\$5	\$
Championship Entries:		\$10 (in total for the 3 items)	\$ Class M1:
		Nil	
Class M2:		\$5	\$

No Entry Fee will be refunded

All Festival Cheques to be payable to: Canterbury Area NZMKS or Internet Banking: 03 0854 0572993-01

Ensure you include your name, membership number and under Reference, 'Comp' when Internet Banking so we know who the deposit is from and what it is for.

Receipts and acknowledgements will be sent by email unless you don't have an email address

**PLEASE INCLUDE A STAMPED SELF ADDRESSED ENVELOPE FOR YOUR GARMENT LABELS.**

Please keep a copy of this form for your records.



**New Zealand Machine Knitters' Society Inc.**

**CAN KNIT – TOO 2019  
“WORKSHOP” BOOKING FORM - PLEASE RETURN WITH REGISTRATION FORM**

Name:.....Membership No:.....

Address:.....Area:.....

	Wednesday 19 <sup>th</sup> June				Thursday 20 <sup>th</sup> June			Friday 21 <sup>st</sup> June		Saturday 22 <sup>nd</sup> June	
	8.45 am	10.45 am	1.00 pm	3.00 pm	8.45 am	10.45 am	1.00 pm	1.00 pm	3.00 pm	8.45 am	10.45 am
1 <sup>st</sup> Choice											
2 <sup>nd</sup> Choice											

**Cost:** \$20 per workshop

Please keep a copy of this form for your records.

**New Zealand Machine Knitters' Society Inc.**

**CAN KNIT - TOO 2019**

**“TOUR” BOOKING FORM - PLEASE RETURN WITH REGISTRATION FORM**

Your Name/s.....

Email address:.....

Contact: Landline ..... Cellphone .....

Tour No.	Day	Departure Time	Cost per person	Number of people	Total cost
1. Dunedin	Wed 19th June	12.00pm	\$60.00		
2. East Otago, Land of Contrast	Thu 20th June	8.30am	\$90.00		
3. Medical Discoveries	Fri 21st June	12.30pm	\$30.00		
4. Coastal Dunedin	Sat 22nd June	9.00am	\$95.00		
				<b>TOTAL COST</b>	

**Any dietary requirements:** .....

Ian Smith 027 232 0138

Please keep a copy of this form for your records

New Zealand Machine Knitters' Society Inc.

**CAN KNIT - TOO 2019**

**“MEALS” BOOKING FORM - PLEASE RETURN WITH REGISTRATION FORM**

Name:.....Membership No:.....

Address:.....

.....Contact:.....

Please indicate which days you will be want morning tea, afternoon tea, lunch and dinner, including the Festival dinner on Saturday night.

<i>Please tick each day you require a meal</i>		Tue 18 June	Wed 19 June	Thu 20 June	Fri 21 June	Sat 22 June	Total No. Days	Total Amount
Morning Tea	\$7/day							\$
Afternoon Tea	\$7/day							\$
Lunch	\$16/day							\$
Dinner (excluding Festival Dinner)	\$28/day							\$
Festival Dinner	\$50							\$

Note any dietary requirements:.....

.....

Meal tickets will be in your registration bag

**New Zealand Machine Knitters' Society Inc.**

**CAN KNIT - TOO 2019 "REGISTRATION" FORM**

Please register by **Monday 13<sup>th</sup> May 2019**. A late fee of \$10 will be incurred if registering after this date.

Email or post registrations to: **Avril Jordan, 157 Ashgrove Terrace, Somerfield, Christchurch 8024**  
 If posting registrations, they must be post marked no later than Monday 13<sup>th</sup> May 2019.

If Internet Banking please email a copy of your Registration Form to **avril.j63@gmail.com** - ensure you note your **Name and Membership Number** and, under Reference, **'Fest Reg'** so we know who the payment is from and what it is for.

All payments to be made by Monday 13<sup>th</sup> May 2019.

Please make cheques out (in NZ dollars) to Canterbury Area NZMKS or Internet Banking 03 0854 0572993-01

Surname:.....

First Name:.....

Address:.....

Telephone No:.....Email:.....

Area:.....Membership No:.....

Preferred Name for Name Badge:.....

Partner's Name:.....Partner's Preferred name for Name Badge:.....

Accommodation and contact Ph. No. (if not staying at Burns Lodge):.....

Are you a:    Councillor    Delegate    Judge    Tutor    Committee    Trade    (please circle)

**Registration and Other Fees Payable**

<b>Details</b>	<b>Cost</b>	<b>No.</b>	<b>Total</b>	<b>Office</b>
Registration Fee	\$70		\$ Late Registration Fee	
– if registering after 13 <sup>th</sup> May 2019	\$10		\$	
Workshop fees from Workshop Form			\$	
Tour Fees from Tour Form			\$	
Meals from Meals Form			\$	
Make and Model Evening	\$10		\$	
<b>Total by Cheque or Internet Banking 03 0854 0572993-01</b>			\$	

**TRAVEL**

Method of travel – Please tick one:    Air.....    Bus.....    Private Car.....

Date of Arrival.....Flight No.....Arrival Time.....

Date of Departure.....Flight No.....Departure Time.....

Do you need to be picked up?    Yes.....    No.....    Cost to be advised

**PLEASE KEEP A COPY OF THIS FORM FOR YOUR RECORDS**

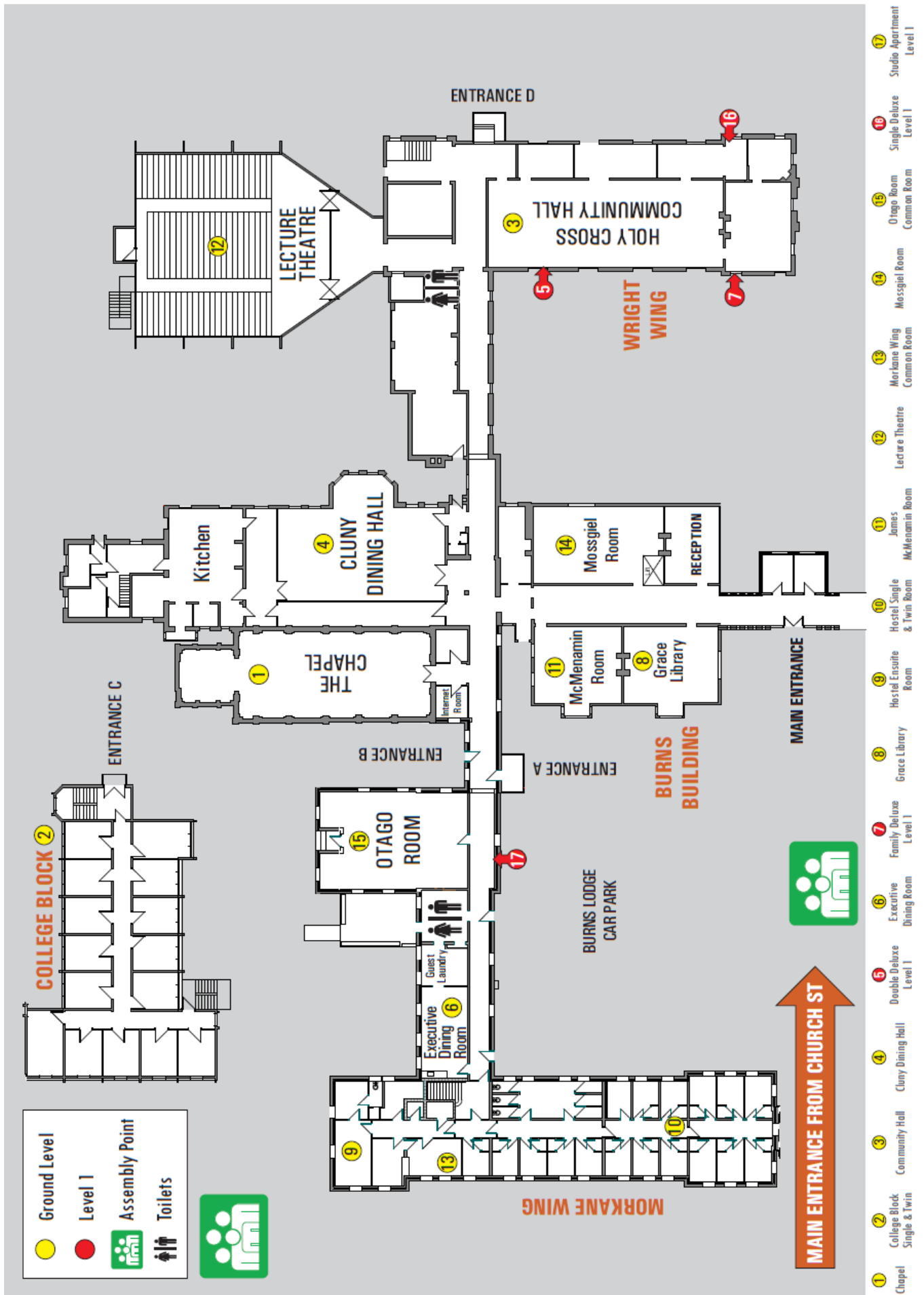



## ACCOMMODATION BED & BREAKFAST GROUP DISCOUNT DEALS

### ALL ACCOMMODATION INCLUDES CONTINENTAL BREAKFAST



#### **College Block Twin Rooms - Total Rooms 22**

Ground level, plus level 1. Includes shared lounge & kitchen facilities

All rooms include bed linen, towels & pillows with 2 x single beds

All rooms have shared bathroom & toilet facilities

1 night stay - \$75 per room

3 night stay - \$195 (\$65pn)

5 night stay - \$275 (\$55pn)

2 night stay - \$140 (\$70pn)

4 night stay - \$240 (\$60pn)



Ground & 1st level in the Monsignor Markane Wing. All rooms include bed linen, towels & pillows.

#### **Single Hostel Room**

Shared bathroom facilities

Shared kitchen facilities

1 x single bed

### **Heritage Hostel Rooms**

#### **Family Hostel Room**

Ensuite, 1 x queen bed,

2 x single beds

Freeview TV

In room tea & coffee

Microwave/fridge

#### **Total Rooms 1**

1 night stay - \$110

2 night stay - \$210 (\$105pn)

3 night stay - \$300 (\$100pn)

4 night stay - \$380 (\$95pn)

5 night stay - \$450 (\$90pn)

#### **Hostel Suite**

Ensuite or separate bathroom

1 x queen bed

Freeview TV/lounge area

In room tea & coffee

Microwave/fridge

#### **Total Rooms 2**

1 night stay - \$90

2 night stay - \$170 (\$85pn)

3 night stay - \$240 (\$80pn)

4 night stay - \$300 (\$75pn)

5 night stay - \$400 (\$80pn)



#### **Single Deluxe Suite**

Ensuite bathroom

1 x single bed

### **Deluxe Rooms**

Located on level 1 in the Wright Wing. All rooms include bed linen, towels & pillows

Plus Freeview TV, tea & coffee, fridge, microwave, iron & ironing board.

#### **Double Deluxe Suite**

Ensuite bathroom

1 x queen bed, 1 x king single

#### **Family Deluxe Suite**

Ensuite bathroom

1 x queen bed, 2 x single

Kitchenette/lounge

#### **Total Rooms 2**

1 night stay - \$70

2 night stay - \$130 (\$65pn)

3 night stay - \$180 (\$60pn)

5 night stay - \$250 (\$50pn)

#### **Total Rooms 3**

1 night stay - \$110

2 night stay - \$210 (\$105pn)

3 night stay - \$300 (\$100pn)

5 night stay - \$450 (\$90pn)

#### **Total Rooms 1**

1 night stay - \$130

2 night stay - \$250 (\$125pn)

3 night stay - \$360 (\$120pn)

5 night stay - \$550 (\$110pn)



## **GROUP RATE**

**2018/2019**

**MUST BOOK DIRECTLY WITH BURNS LODGE TO ACCESS DISCOUNTED ROOM RATE**

**CALL 03 489 2600 EMAIL: [bronwyn@burnslodge.nz](mailto:bronwyn@burnslodge.nz)**

CANCELLATION TERMS APPLY, CREDIT CARD REQUIRED TO SECURE BOOKING

MORE INFORMATION CAN BE FOUND ON OUR WEBSITE

[www.burnslodge.nz](http://www.burnslodge.nz)

**89 Church Street, Mosgiel, Dunedin**

## **Day Registration Form**

Hello Members,

At the NZMKS Inc Council Meeting in 2018, it was decided that we would, as a trial for this year, allow NZMKS Inc members, who wish to attend Festival for one day only, a reduced Registration Fee which includes a copy of the Workshop Book, but the Workshop Fee/s are over and above the Registration Fee. This is strictly on a 'one day only per Festival' basis.

Attached is the 'Day Registration Form' for Can Knit – Too 2019, which was inadvertently left out of the Festival Newsletter. The Registration Fee for 'One Day' attendees at Can Knit – Too 2019 will be \$25 plus \$20 per Workshop booked and extra any meals ordered. Please use the relevant forms in the Festival Newsletter for other than your Day Registration.

Your Can Knit – Too 2019 Committee

**New Zealand Machine Knitters' Society Inc.**

**CAN KNIT - TOO 2019 "DAY REGISTRATION" FORM**

Please register by **Monday 13 May 2019**. A late fee of \$10 will be incurred if registering after this date.

Email or post registrations to: **Avril Jordan, 157 Ashgrove Terrace, Somerfield, Christchurch 8024**

If posting registrations, they must be post marked no later than Monday 13 May 2019.

If Internet Banking please email a copy of your Registration Form to **avril.j63@gmail.com** - ensure you note your **Name and Membership Number** and, under Reference, **'Fest Reg'** so we know who the payment is from and what it is for.

All payments to be made by Monday 13 May 2019.

Please make cheques out (in NZ dollars) to Canterbury Area NZMKS or Internet Banking 03 0854 0572993-01

Surname:.....

First Name:.....

Address:.....

Telephone No:..... Email:.....

Area:..... Membership No:.....

Preferred Name for Name Badge:.....

**Registration and Other Fees Payable**

Details	Cost	No.	Total	Office
Registration Fee	\$25		\$	
Late Registration Fee – if registering after 13 May 2019	\$10		\$	
Workshop fees from Workshop Form			\$	
Meals from Meals Form			\$	
Make and Model Evening	\$10		\$	
<b>Total by Cheque or Internet Banking 03 0854 0572993-01</b>			\$	

**PLEASE KEEP A COPY OF THIS FORM FOR YOUR RECORDS**